

Basement Floor Plan  
Ceiling Height = 7'-0"

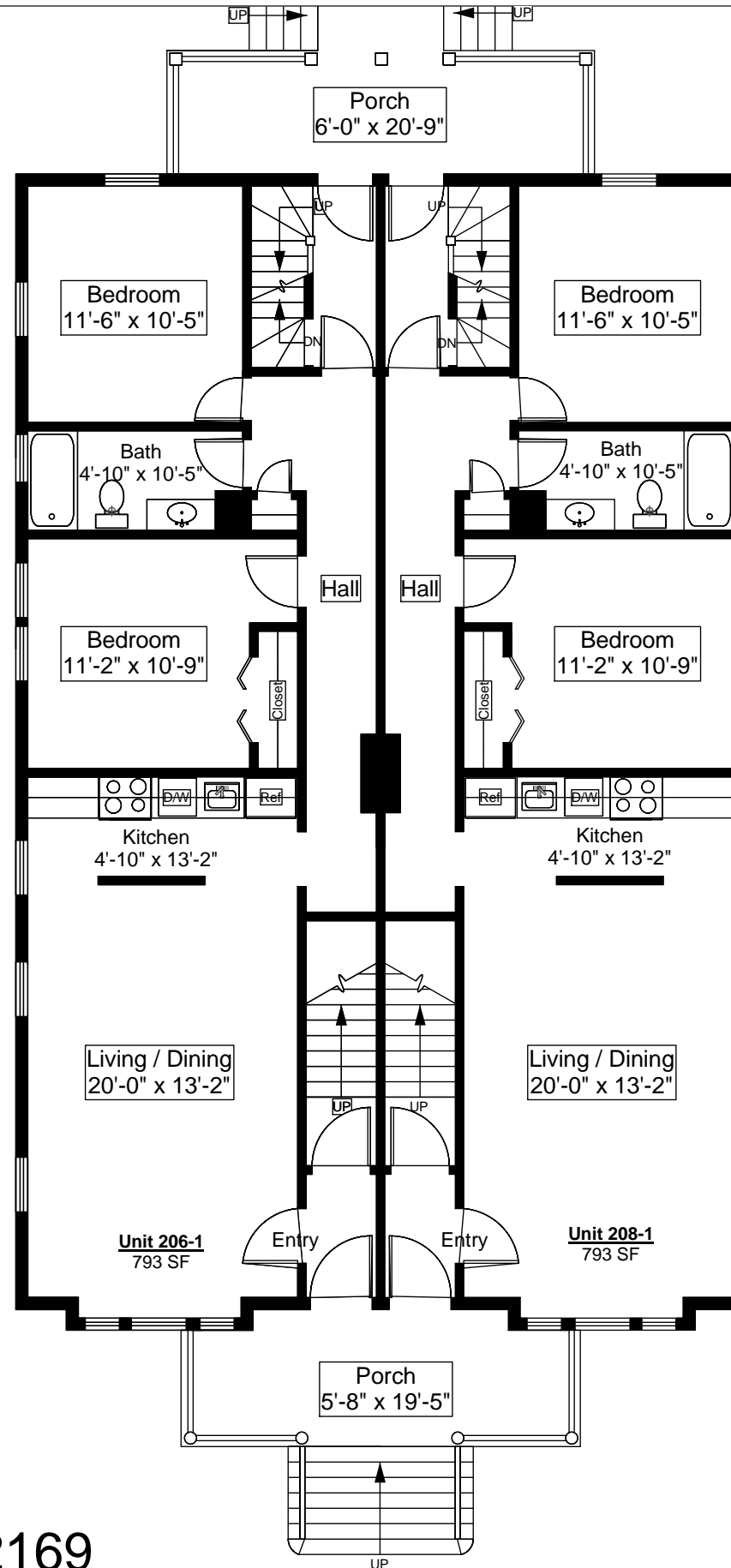

First Floor Plan  
Ceiling Height = 8'-5"

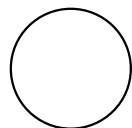

206 - 208 Federal Avenue, Quincy, MA 02169

SCALE: 1/8" = 1'-0"



the  
**HOLLAND  
COMPANIES**

Design & Construction

1126 Main Street  
Weymouth, MA  
02190

Phone 781.335.4275  
Fax 781.340.0077

thehollandcompanies.com

Note - Dimensions are  
not guaranteed and are  
provided for informational  
purposes only.

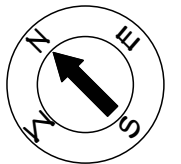

PRINT DATE:  
August 2009

PROJECT NAME:  
Rental Property

PROJECT ADDRESS:  
206 - 208 Federal Avenue  
Quincy, MA

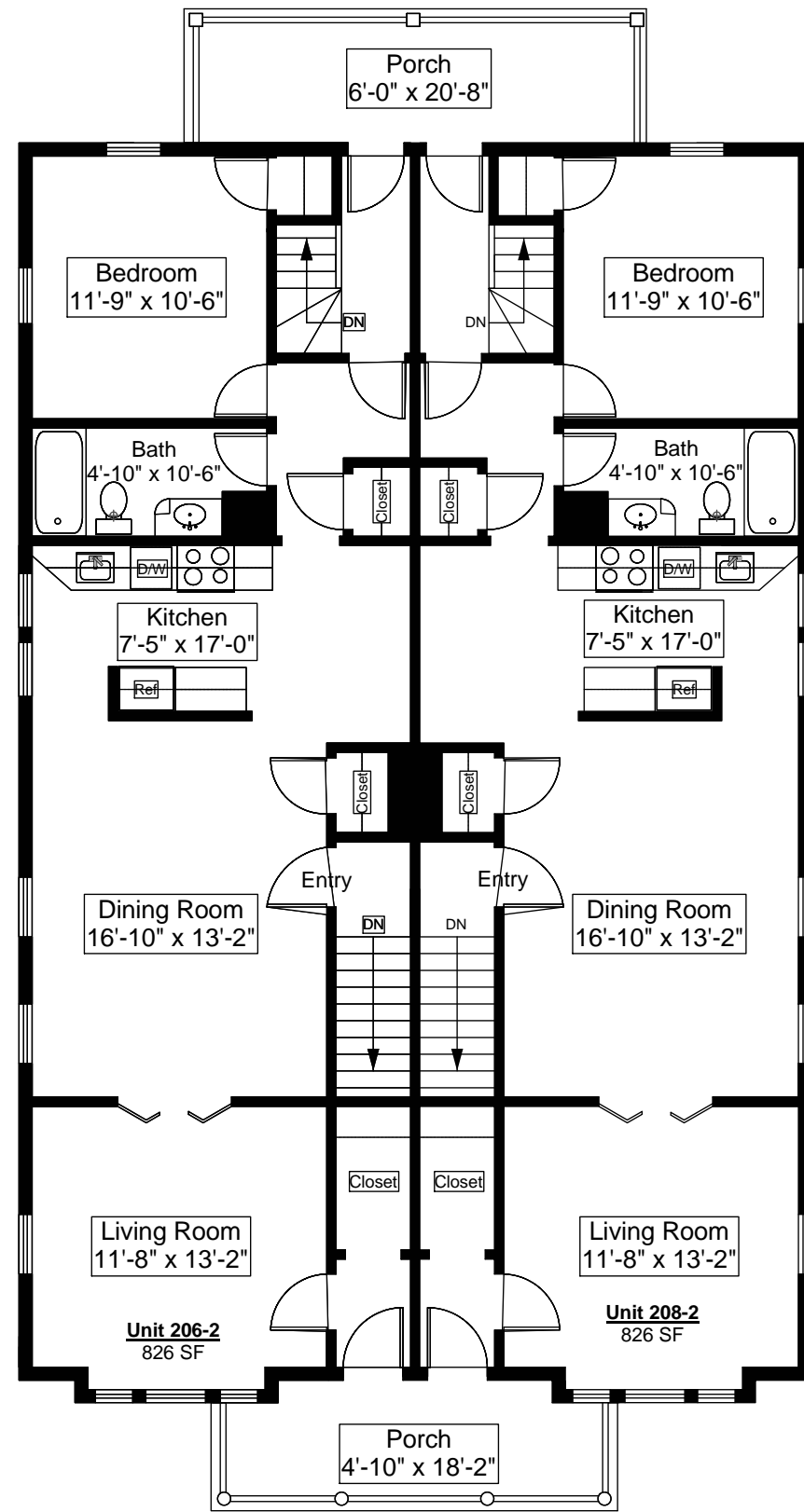

Second Floor Plan  
Ceiling Height = 8'-5"

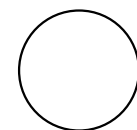

206 - 208 Federal Avenue, Quincy, MA 02169

SCALE: 1/8" = 1'-0"



the  
**HOLLAND  
COMPANIES**

Design & Construction

1126 Main Street  
Weymouth, MA  
02190

Phone 781.335.4275  
Fax 781.340.0077

thehollandcompanies.com

Note - Dimensions are not guaranteed and are provided for informational purposes only.

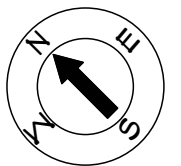

PRINT DATE:  
August 2009

PROJECT NAME:  
Rental Property

PROJECT ADDRESS:  
206 - 208 Federal Avenue  
Quincy, MA